

Thank you for purchasing this Dynojet kit. This kit has been developed for a motorcycle which is set to the parameters listed at the right in the "Stage" description. If your motorcycle does not meet any of these parameters please check with Dynojet before installation. For technical assistance contact your Dynojet distributor or call Dynojet U.S.A. (800)-992-4993



WARNING

**NO SMOKING!
NO OPEN FLAME!
WHILE INSTALLING
YOUR DYNOJET KIT**

2191 Mendenhall Dr. Suite 105
North Las Vegas, NV 89081
TEL: 702-399-1423
FAX: 702-399-1431
8am-5pm Pacific Time
Monday through Friday

Website Address
<http://www.dynojet.com>

The manufacturer and seller make no warranties express or implied which extend beyond the description of the goods contained herein. Any description of this product is for the purpose of identifying it and shall not be deemed to create an express warranty.

1148.002

U.S Models Only

1992~2009 Honda XR650L

Stage 1

For mildly tuned machines using the stock airbox, with stock or K&N filter. May also be used with a good aftermarket exhaust system
K&N filter #HA-6592

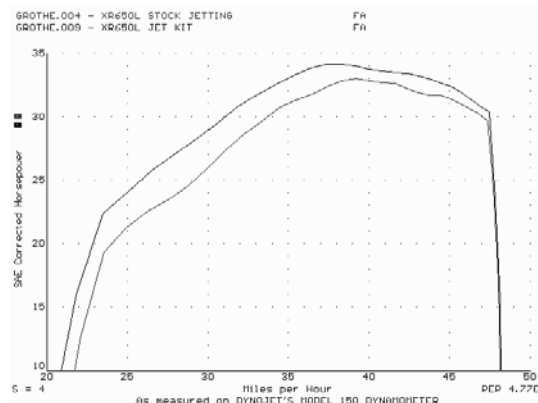

This graph shows a typical gain with a Dynojet jet kit.

Parts List

1	Main Jet	DJ160
1	Main Jet	DJ165
1	Fuel Needle	DNO130
1	Adjusting Washer	DE0001
1	E-clip	DW0001
1	Slide Spring	DSP012

STAGE ONE INSTRUCTIONS

1. Remove the vacuum slide from the carb. Remove the stock needle and spacers, noting the order of assembly (Fig. A).

2. Install the Dynojet needle on groove #3 from the top. Use all stock spacers (Fig. A). Install the small Dynojet washer above the E-clip. Install the Dynojet slide spring (DSP012) in place of the stock slide spring. After installing the slide in the carb be sure to check slide movement manually before carburetor installation.

3. Remove the stock main jet and replace with Dynojet main jet provided. If you are using the stock exhaust install the DJ160 main jet. If you are using an aftermarket exhaust or slip-on with a high flowing baffle, use the DJ165 main jet. **NOTE:** This kit was designed with the stock airbox in place and stock exhaust. Due to the carb bell mouth design, it is recommended that only the air filter be modified to enhance air flow. Be sure that the jet you are changing is the main jet.

4. Locate the fuel mixture tab (Fig. B). Carefully turn the mixture tab clockwise until lightly seated, then turn out 2-1/2 turns or until the best idle is achieved.

Dynojet

1148.002

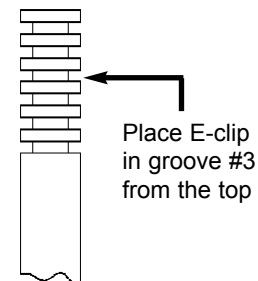

Fig. A

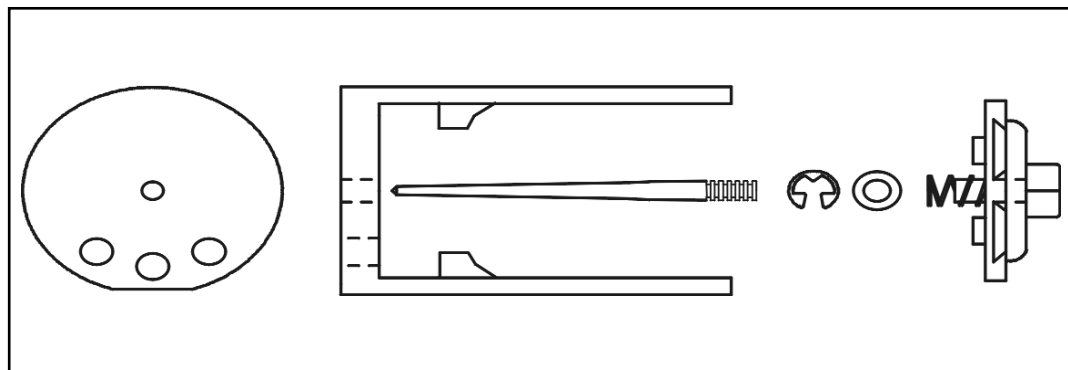

Fig. B

