

Thank you for purchasing this Dynojet kit. This kit has been developed for a motorcycle which is set to the parameters listed at the right in the "Stage" description. If your motorcycle does not meet any of these parameters please check with Dynojet before installation. For technical assistance contact your Dynojet distributor or call Dynojet U.S.A. (800)-992-4993



2141.002

U.S Models Only

1990 Kawasaki ZX7

Stage 1

For mildly tuned machines using the stock airbox, with stock filter. May also be used with a good aftermarket exhaust system
K&N filter #N/A

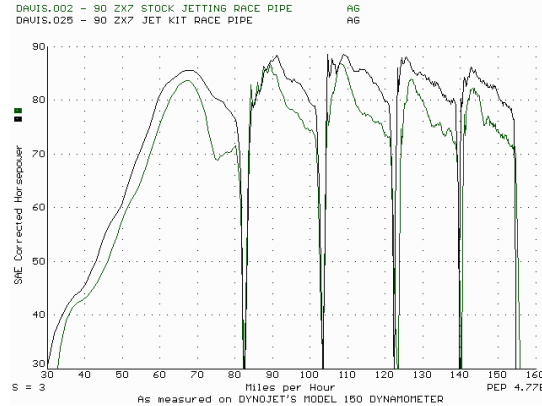

This graph shows a typical gain with a Dynojet jet kit.

WARNING

**NO SMOKING!
NO OPEN FLAME!
WHILE INSTALLING
YOUR JET KIT**

2191 Mendenhall Dr. Suite 105
North Las Vegas, NV 89031
TEL: 702-399-1423
FAX: 702-399-1431
8am-5pm Pacific Time
Monday through Friday

Website Address
<http://www.dynojet.com>

The manufacturer and seller make no warranties express or implied which extend beyond the description of the goods contained herein. Any description of this product is for the purpose of identifying it and shall not be deemed to create an express warranty.

Parts List

4	Main Jets	DJ112
4	Main Jets	DJ118
1	Slide Drill	DD #7/64
4	Fuel Needles	DNO228
8	Adjusting Washers	DW0001
4	E-clips	DE0001
4	Slide Springs	DSP005
1	Glue	DA0001
4	Main Air Correctors	DCO201
1	Tool	DT001
1	Plug Drill	DD #5/32
1	Screw	DS0001

STAGE ONE INSTRUCTIONS

DYNOJET
2141.002

1. Remove the vacuum slides from the carbs. Remove the stock needles and spacers, noting order of assembly (Fig.A). Using the DD #7/64 slide drill provided, enlarge your slide lift holes. Do not drill the needle hole.
2. Install the Dynojet needles on groove #4 from the top. Use all stock spacers. Install the small Dynojet washers above the E-clip (2 per needle). After installing the slides in the carbs be sure to check slide movement manually. Install the Dynojet slide springs (DSP005) in place of the stock slide springs.
3. Remove the stock main jets and replace with the Dynojet main jets provided. If you are running the stock exhaust install the DJ112 main jets. If you are running an aftermarket exhaust or slip-on with high flowing baffle use the DJ118 main jets. Be sure that the jet you are changing is the main jet.
4. Locate the main air jet passage (Fig. B). With the flat end facing into the carb, install the main air correctors (DCO201) provided. Use the tool provided to tap lightly in place. With the glue provided lightly touch a dab on the outer edge of the air corrector. Allow the glue to dry.
5. Locate the fuel mixture plug (Fig. C). If you see a screw head at Fig. C then proceed to the adjusting procedure. With the DD #5/32 drill bit provided carefully drill through the plug. **NOTE:** The mixture screw is directly underneath this plug, be ready to pull back on the drill the instant you break through. Use screw provided to secure and remove this plug. Carefully turn the mixture screws clockwise until lightly seated, then back out 3 turns.

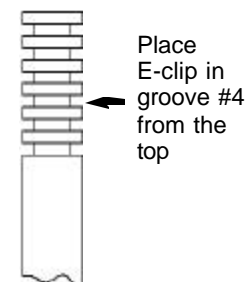

Fig. A

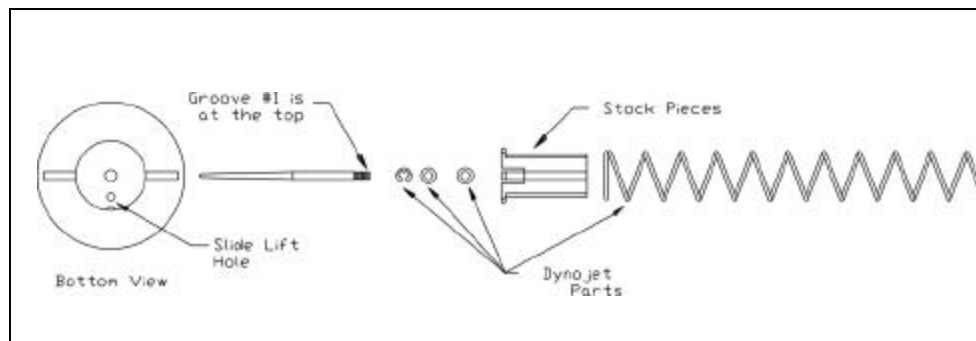

Fig. B

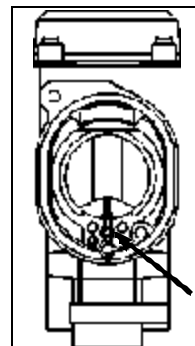

Fig. C

