

Thank you for purchasing this Dynojet kit. This kit has been developed for a motorcycle which is set to the parameters listed at the right in the "Stage" description. If your motorcycle does not meet any of these parameters please check with Dynojet before installation. For technical assistance contact your Dynojet distributor or call Dynojet U.S.A. (800)-992-4993



2152.001

U.S Models Only

2009 Kawasaki KLX250S

Stage 1 & 2

STAGE 1

For mildly tuned machines using the stock airbox, with stock or K&N filter.

STAGE 2

For mildly tuned machines using stock airbox with intake snorkel removed, with the stock or K&N filter.

Both stages may be used with a good aftermarket exhaust

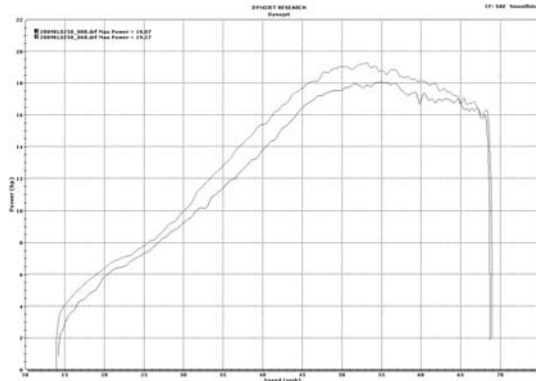

This graph shows a typical gain with a Dynojet jet kit.

2191 Mendenhall Dr. Suite 105
North Las Vegas, NV 89081
TEL: 702-399-1423
FAX: 702-399-1431
8am-5pm Pacific Time
Monday through Friday

Website Address
<http://www.dynojet.com>

The manufacturer and seller make no warranties express or implied which extend beyond the description of the goods contained herein. Any description or this product is for the purpose of identifying it and shall not be deemed to create an express warranty.

WARNING

**NO SMOKING!
NO OPEN FLAME!
WHILE INSTALLING
YOUR DYNOJET KIT**

Parts List		
1	Main Jet	DJ112
1	Main Jet	DJ116
1	Main Jet	DJ120
1	Main Jet	DJ124
1	Main Jet	DJ128
1	Main Jet	DJ132
1	Fuel Needle	DNO228
1	E-clip	DE0001
2	Adjusting Washers	DW0001
1	Slide Spring	DSP027
1	Plug Drill	DD 5/32
1	Screw	DS0001

STAGE ONE INSTRUCTIONS

1. Remove the vacuum slide from the carb. Remove the stock needle and spacers, noting order of assembly (Fig. A).
2. Install the Dynojet needle on groove #3 from the top. Install the small Dynojet washers above the e-clip. Install the Dynojet slide spring (DSP027) in place of the stock slide spring. After installing the slide in the carb be sure to check slide movement manually.
3. Remove the stock main jet and replace with the Dynojet main jet provided. If you are running the stock exhaust install the DJ116 main jet. If you are running an aftermarket exhaust or slip-on with high flowing baffle use the DJ120 main jet. Be sure that the jet you are changing is the main jet.
4. Locate the fuel mixture plug (Fig. B). If you see a screw head at Fig.B then proceed to the adjusting procedure. With the 5/32 drill bit provided carefully drill through the plug. **NOTE: The mixture screw is directly underneath this plug, be ready to pull back on the drill the instant you break through.** Use screw provided to secure and remove this plug. Carefully turn the mixture screw clockwise until lightly seated, then back out 3 turns.

Fig. A

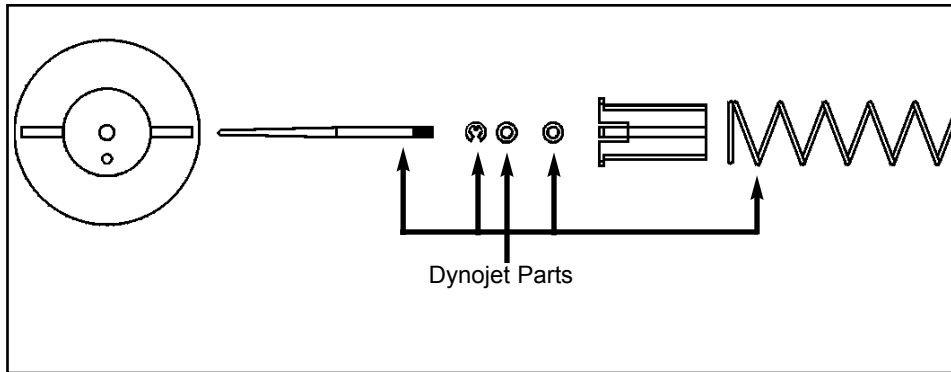

STAGE TWO INSTRUCTIONS

Dynojet

2152.001

1. Remove the vacuum slides from the carbs. Remove the stock needle and spacers, noting order of assembly (Fig. A).
2. Install the Dynojet needle on groove #3 from the top. Install the small Dynojet washers above the e-clip. Install the Dynojet slide spring (DSP027) in place of the stock slide spring. After installing the slide in the carb be sure to check slide movement manually.
3. Remove the stock main jet and replace with the Dynojet main jet provided. If you are running the stock exhaust install the DJ124 main jet. If you are running an aftermarket exhaust or slip-on with high flowing baffle use the DJ128 main jet. Be sure that the jet you are changing is the main jet.
4. Locate the fuel mixture plug (Fig. B). If you see a screw head at Fig.B then proceed to the adjusting procedure. With the 5/32 drill bit provided carefully drill through the plug. **NOTE: The mixture screw is directly underneath this plug, be ready to pull back on the drill the instant you break through.** Use screw provided to secure and remove this plug. Carefully turn the mixture screw clockwise until lightly seated, then back out 3 turns.

Fig. B

