

Thank you for purchasing this Dynojet kit. This kit has been developed for a motorcycle which is set to the parameters listed at the right in the "Stage" description. If your motorcycle does not meet any of these parameters please check with Dynojet before installation. For technical assistance contact your Dynojet distributor or call Dynojet U.S.A. (800)-992-4993



3107.001

U.S Models Only

**2000-2010 Suzuki LS650
Savage / S40
Stage 1**

For mildly tuned machines using the stock airbox, with stock filter. May also be used with a good aftermarket exhaust system.

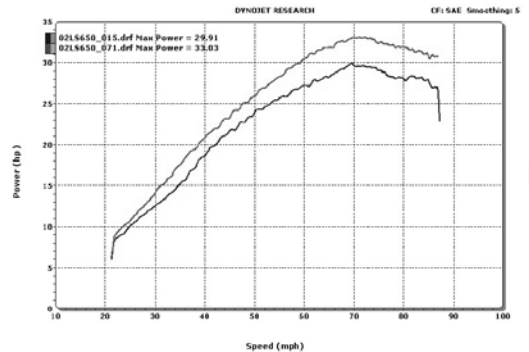

This graph shows a typical gain with a Dynojet jet kit.

WARNING

**NO SMOKING!
NO OPEN FLAME!
WHILE INSTALLING
YOUR DYNOJET KIT**

2191 Mendenhall Dr. Suite 105
North Las Vegas, NV 89081
TEL: 702-399-1423
FAX: 702-399-1431
8am-5pm Pacific Time
Monday through Friday

Website Address
<http://www.dynojet.com>

The manufacturer and seller make no warranties express or implied which extend beyond the description of the goods contained herein. Any description of this product is for the purpose of identifying it and shall not be deemed to create an express warranty.

Parts List

1	Main Jet	DJ138
1	Main Jet	DJ140
1	Main Jet	DJ142
1	Main Jet	DJ144
1	Main Jet	DJ146
1	Fuel Needle	DNO618
1	E-clip	DE0001
1	Adjusting Washer	DW0001
1	Plug Drill	DD 5/32
1	Screw	DS0001

STAGE ONE INSTRUCTIONS

Dynojet

3107.001

1. Remove the vacuum slide from the carb. Remove the stock needle and spacers, noting order of assembly (Fig.A).
2. Install the Dynojet needle on groove #4 from the top. Use all stock spacers (Fig. A). After installing the slides in the carbs be sure to check slide movement manually.
3. Remove the stock main jet and replace with the Dynojet main jet provided. If you are running the stock exhaust install the DJ140. If you are running an aftermarket exhaust or slip-on with high flowing baffle use the DJ144. Be sure that the jet you are changing is the main jet.
4. Locate the fuel mixture plug (Fig. B). If you see a screw head at Fig.B then proceed to the adjusting procedure. With the 5/32 drill bit provided carefully drill through the plug. **NOTE: The mixture screw is directly underneath this plug, be ready to pull back on the drill the instant you break through.** Use screw provided to secure and remove this plug. Carefully turn the mixture screw clockwise until lightly seated, then back out 1.5 turns.

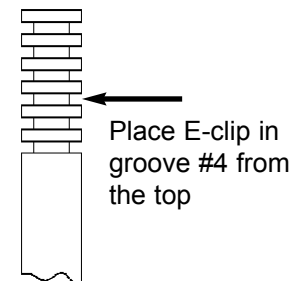

Fig. A

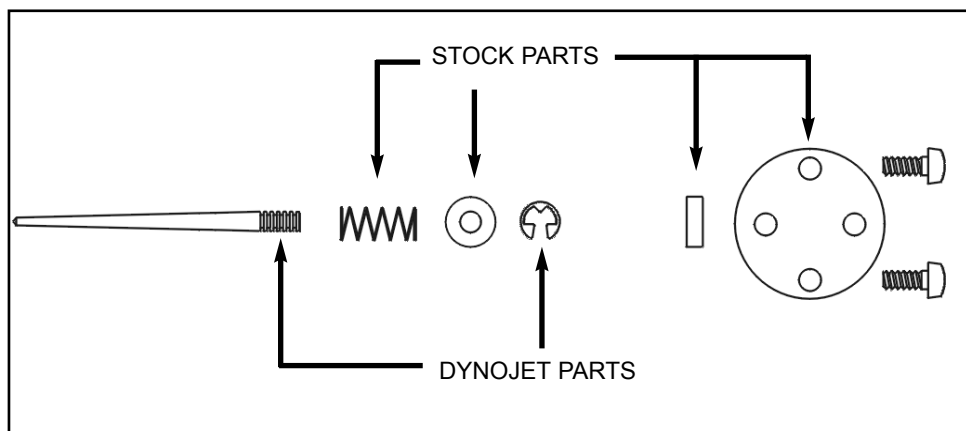

Fig. B

MIXTURE SCREW

