

Thank you for purchasing this Dynojet kit. This kit has been developed for a motorcycle which is set to the parameters listed at the right in the "Stage" description. If your motorcycle does not meet any of these parameters please check with Dynojet before installation. For technical assistance contact your Dynojet distributor or call Dynojet U.S.A. (800)-992-4993

2191 Mendenhall Dr. Suite 105
 North Las Vegas, NV 89081
 TEL: 702-399-1423
 FAX: 702-399-1431
 8am-5pm Pacific Time
 Monday through Friday

Website Address
<http://www.dynojet.com>

The manufacturer and seller make no warranties express or implied which extend beyond the description of the goods contained herein. Any description of this product is for the purpose of identifying it and shall not be deemed to create an express warranty.



3110.002
 U.S Models Only

2005-2017 Suzuki DRZ400SM

Stage 1 & 2

Stage 1

For mildly tuned machines using the stock airbox, with stock or K&N filter. May also be used with a good aftermarket exhaust system. K&N filter # SU-4000

Stage 2

For mildly tuned machines with then top of the airbox opened up 3in X 3in, with stock or K&N filter. Should also be used with a good aftermarket exhaust system. K&N filter # SU-4000

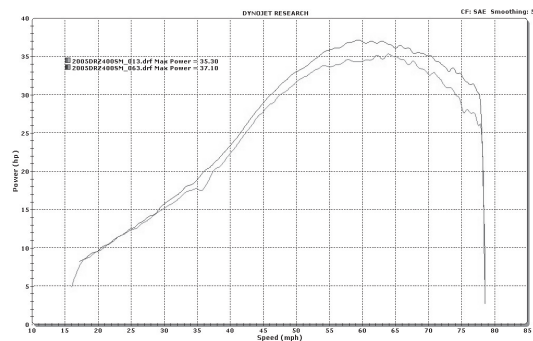

This graph shows a typical gain with a Dynojet jet kit.

WARNING

**NO SMOKING!
 NO OPEN FLAME!
 WHILE INSTALLING
 YOUR DYNOJET KIT**

PARTSLIST		
1	Main Jet	DJ126
1	Main Jet	DJ130
1	Main Jet	DJ134
1	Main Jet	DJ138
1	Main Jet	DJ142
1	Main Jet	DJ146
1	Main Jet	DJ150
1	Main Jet	DJ155
1	Fuel Needle	DNO308
1	E-Clip	DE0001
1	Adjusting Washer	DW0001
1	Slide Spring	DSP026
1	Needle Spring	DSP77
1	Slide Drill	DD 32
1	Screw	DS0001
1	Plug Drill	DD 5/32

STAGE ONE INSTRUCTIONS

1. Remove the vacuum slide from carb. Remove stock needle and spacer, noting order of assembly (Fig. A).
2. Install the Dynojet needle on groove #4 from the top. Use all stock spacers (Fig. A). The small Dynojet washer is for half step increments and does not have to be installed at this time. Install the Dynojet slide spring (DSP026) in place of the stock slide spring. **NOTE: The DSP77 spring does not have to be used, it is supplied in case the stock spring is misplaced.** After installing the slide in the carb be sure to check slide movement manually before airbox installation.
3. Remove the stock a main jet and replace with the Dynojet main jet provided. If you are running the stock exhaust install, the DJ130 main jet. If you are running an aftermarket exhaust or slip-on with a high flowing baffle, use the DJ134 main jet. Be sure that the jet you are changing is the main jet.
4. Locate the fuel mixture plug (Fig. B). If you see a screw head at Fig. B proceed to adjusting procedure. With the 5/32 drill bit provided carefully drill through the plugs. **NOTE: The mixture screw is directly underneath this plug, be ready to pull back on the drill the instant you break through.** Use screw provided to secure and remove this plug. Carefully turn mixture screws clockwise until lightly seated, then back out 3.5 turns.

Fig. A

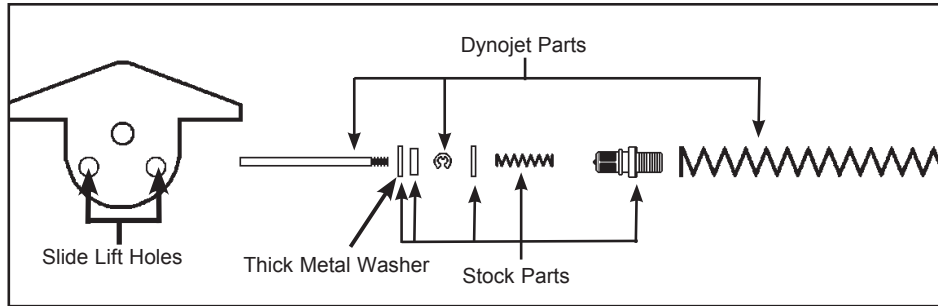

STAGE TWO INSTRUCTIONS

Note: When using Stage 2 you must modify the airbox. Cut a 3in X 3in hole in the top of the airbox, at the location of the stock intake snorkle.

1. Remove the vacuum slide from carb. Remove stock needle and spacer, noting order of assembly (Fig. A). Drill the slide lift holes with the DD 32 drill provided (Fig. A)
2. Install the Dynojet needle on groove #4 from the top. Use all stock spacers (Fig. A). The small Dynojet washer is for half step increments and does not have to be installed at this time. Install the Dynojet slide spring (DSP026) in place of the stock slide spring. **NOTE: The DSP77 spring does not have to be used, it is supplied in case the stock spring is misplaced.** After installing the slide in the carb be sure to check slide movement manually before airbox installation.
3. Remove the stock a main jet and replace with the Dynojet main jet provided. If you are running the stock exhaust install, the DJ142 main jet. If you are running an aftermarket exhaust or slip-on with a high flowing baffle, use the DJ146 main jet. Be sure that the jet you are changing is the main jet.
4. Locate the fuel mixture plug (Fig. B). If you see a screw head at Fig. B proceed to adjusting procedure. With the 5/32 drill bit provided carefully drill through the plugs. **NOTE: The mixture screw is directly underneath this plug, be ready to pull back on the drill the instant you break through.** Use screw provided to secure and remove this plug. Carefully turn mixture screws clockwise until lightly seated, then back out 3.5 turns.

Dynojet

3110.002

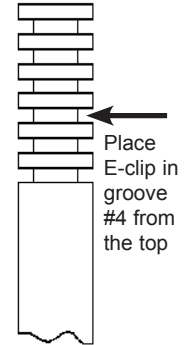

Fig. B

