

Thank you for purchasing this Dynojet kit. This kit has been developed for a motorcycle which is set to the parameters listed at the right in the "Stage" description. If your motorcycle does not meet any of these parameters please check with Dynojet before installation. For technical assistance contact your Dynojet distributor or call Dynojet U.S.A. (800)-992-4993

2191 Mendenhall Dr. Suite 105
 North Las Vegas, NV 89031
 TEL: 702-399-1423
 FAX: 702-399-1431
 8am-5pm Pacific Time
 Monday through Friday

Website Address
<http://www.dynojet.com>

The manufacturer and seller make no warranties express or implied which extend beyond the description of the goods contained herein. Any description of this product is for the purpose of identifying it and shall not be deemed to create an express warranty.



3125.002

U.S Models Only

1980-85 Suzuki GS700

All Models

Stage 1 & 3

STAGE 1

For mildly tuned machines using the stock airbox, with stock or K&N filter. K&N filter #SU-7503

STAGE 3

For mildly tuned machines using individual filters or velocity stacks. K&N filter #RC-0984

Both stages may also be used with a good aftermarket exhaust

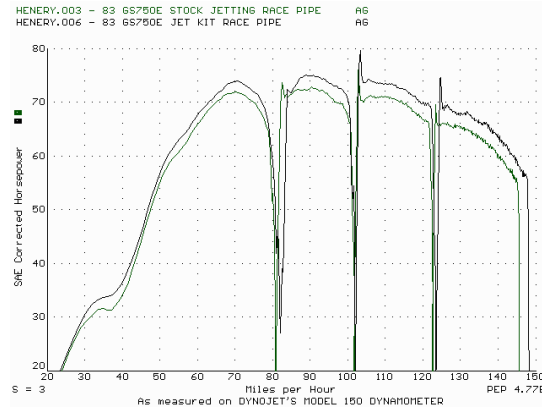

This graph shows a typical gain with a Dynojet jet kit.

WARNING

**NO SMOKING!
 NO OPEN FLAME!
 WHILE INSTALLING
 YOUR DYNQJET KIT**

Parts List

4	Main Jets	DJ114
4	Main Jets	DJ118
4	Main Jets	DJ130
4	Main Jets	DJ134
1	Slide Drill	DD #5/32
4	Fuel Needles	DNT604
4	Adjusting Washers	DW0001
4	E-clips	DE0001
1	Screw	DS0001

STAGE ONE INSTRUCTIONS

1. Remove the vacuum slides from the carbs. Remove the stock needles and spacers, noting the order of assembly (Fig. A). Using the DD #5/32 drill bit provided, enlarge the lift hole (Fig. A).

Do not drill the needle hole.

2. Install the Dynojet needles on groove #2. Use all stock spacers (Fig. A). Install the small Dynojet washers above the e-clip. After installing the slides in the carbs be sure to check slide movement manually.

3. Remove the main jet and replace with the Dynojet main jets provided. If you are running the stock exhaust install the DJ114 main jets. If you are running an aftermarket exhaust or slip-on with a high flowing baffle, use the DJ118 main jets. Be sure that the jets you are changing are the main jets.

4. Locate the fuel mixture plug (Fig. B). If you see a screw head at Fig. B proceed to adjusting procedure. With the DD #5/32 drill bit provided carefully drill through the plugs. **NOTE:** The mixture screw is directly underneath this plug, be ready to pull back on the drill the instant you break through. Use screw provided to secure and remove this plug. Carefully turn mixture screws clockwise until lightly seated, then back out 3 turns.

STAGE THREE INSTRUCTIONS

1. Remove the vacuum slides from the carbs. Remove the stock needles and spacers, noting the order of assembly (Fig. A). Using the DD #5/32 drill bit provided, enlarge the slide lift hole (Fig. A).

Do not drill the needle hole.

2. Install the Dynojet needles on groove #3. Use all stock spacers (Fig. A). Install the small Dynojet washers above the e-clip. After installing the slides in the carbs be sure to check slide movement manually.

3. Remove the main jet and replace with the Dynojet main jets provided. If you are running the stock exhaust install the DJ130 main jets. If you are running an aftermarket exhaust or slip-on with a high flowing baffle, use the DJ134 main jets. Be sure that the jets you are changing are the main jets.

4. Locate the fuel mixture plug (Fig. B). If you see a screw head at Fig. B proceed to adjusting procedure. With the DD #5/32 drill bit provided carefully drill through the plugs. **NOTE:** The mixture screw is directly underneath this plug, be ready to pull back on the drill the instant you break through. Use screw provided to secure and remove this plug. Carefully turn mixture screws clockwise until lightly seated, then back out 3 turns.

Fig. A

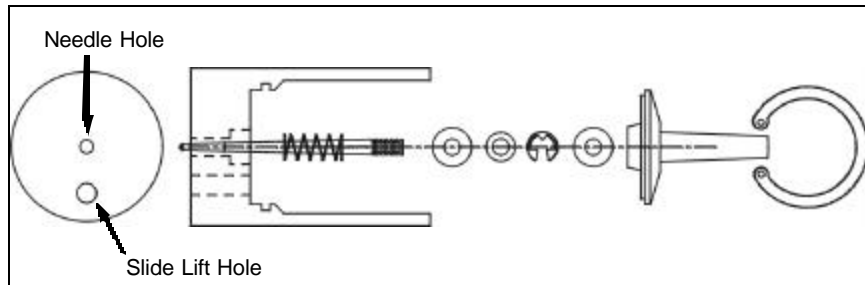

Fig. B

