

Thank you for purchasing this Dynojet kit. This kit has been developed for a motorcycle which is set to the parameters listed at the right in the "Stage" description. If your motorcycle does not meet any of these parameters please check with Dynojet before installation. For technical assistance contact your Dynojet distributor or call Dynojet U.S.A. (800)-992-4993

2191 Mendenhall Dr. Suite 105
 North Las Vegas, NV 89031
 TEL: 702-399-1423
 FAX: 702-399-1431
 8am-5pm Pacific Time
 Monday through Friday

Website Address
<http://www.dynojet.com>

The manufacturer and seller make no warranties express or implied which extend beyond the description of the goods contained herein. Any description of this product is for the purpose of identifying it and shall not be deemed to create an express warranty.



3140.002

U.S Models Only

1992-93 Suzuki GSXR600

Stage 1

For mildly tuned machines using the stock airbox, with stock or K&N filter. May also be used with a good aftermarket exhaust system
 K&N filter #SU-7593

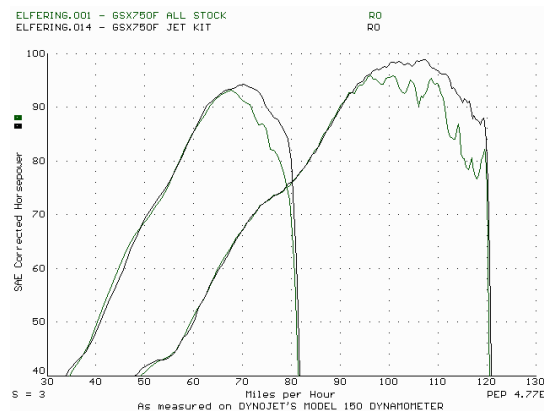

This graph shows a typical gain with a Dynojet jet kit.

WARNING

**NO SMOKING!
 NO OPEN FLAME!
 WHILE INSTALLING
 YOUR DYNOJET KIT**

Parts List

4	Main Jet	DJ102
4	Main Jet	DJ104
4	Main Jet	DJ106
4	Main Jet	DJ108
4	Main Jet	DJ112
4	Fuel Needles	DNO362
4	Adjusting Washers	DW0001
4	E-Clips	DE0001
4	Slide Springs	DSP007
1	Plug Drill	DD #5/32
1	Screw	DS0001

STAGE ONE INSTRUCTIONS

1. Remove the vacuum slide from the carbs. Remove the stock needles & spacers, noting the order of assembly.
2. Install the Dynojet needles on groove #2, using all stock spacers (Fig. A). Install the Dynojet washer above the E-clip.
3. Remove the main jet and replace with the Dynojet main jets provided. Use the DJ102 main jets with stock exhaust pipe and stock air filter or use the DJ108 main jets with a K&N filter and stock pipe. With an aftermarket header or slip-on with high flowing baffles, use the DJ106 main jets with the stock filter and the DJ112 main jets when running the K&N filter. Be sure that the jets you are changing are the main jets.
4. Install the Dynojet springs in place of the stock springs.
5. Locate the fuel mixture plug (Fig. B), if you see a screw head, proceed to adjusting procedure. With the 5/32 drill provided, carefully drill thru the plugs. NOTE: the mixture screw is directly underneath this plug, be ready to pull back on the drill the instant you break thru. Use screw provided to secure and remove the plug. Carefully turn mixture screw clockwise until seated, then back out 2-1/2 turns.

DYNOJET

3140.002

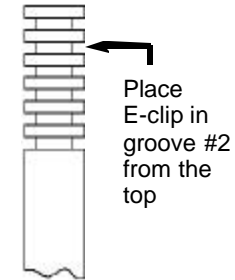

Fig. A

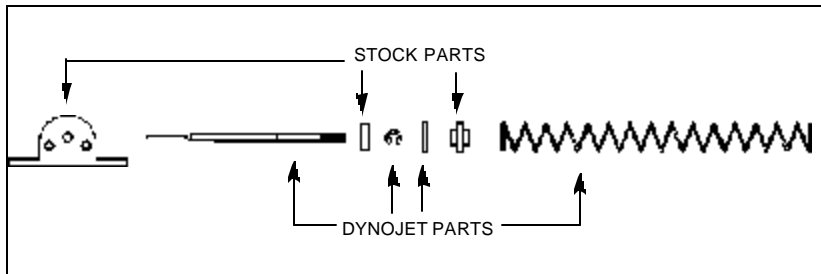

Fig. B

