

Thank you for purchasing this Dynojet kit. This kit has been developed for a motorcycle which is set to the parameters listed at the right in the "Stage" description. If your motorcycle does not meet any of these parameters please check with Dynojet before installation. For technical assistance contact your Dynojet distributor or call Dynojet U.S.A. (800)-992-4993

2191 Mendenhall Dr. Suite 105  
 North Las Vegas, NV 89031  
 TEL: 702-399-1423  
 FAX: 702-399-1431  
 8am-5pm Pacific Time  
 Monday through Friday

Website Address  
<http://www.dynojet.com>

The manufacturer and seller make no warranties express or implied which extend beyond the description of the goods contained herein. Any description of this product is for the purpose of identifying it and shall not be deemed to create an express warranty.



**3163CA.001**

California Models Only

*1999-2000 Suzuki GSXR 600*

**Stage 1**

For mildly tuned machines using the stock airbox, with stock or K&N filter. May also be used with a good aftermarket exhaust system  
 K&N filter #SU-7596

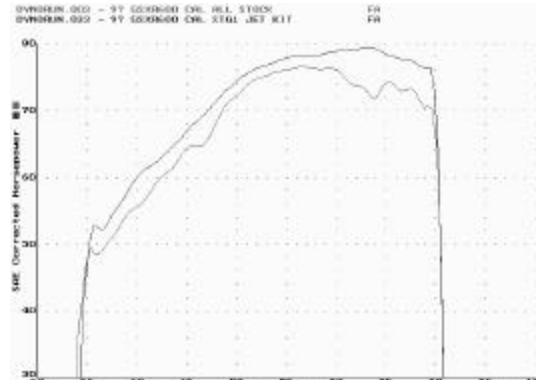

This graph shows a typical gain with a Dynojet jet kit.

# WARNING

**NO SMOKING!  
 NO OPEN FLAME!  
 WHILE INSTALLING  
 YOUR DYNOJET KIT**

Parts List		
2	Main Jets	DJ122
2	Main Jets	DJ124
2	Main Jets	DJ126
2	Main Jets	DJ128
2	Main Jets	DJ130
2	Main Jets	DJ132
4	Fuel Needles	DNO255
4	Adjusting Washers	DW0001
4	E-Clips	DE0001
4	Needle Springs	DSP77
1	Plug Drill	DD #5/32
1	Screw	DS0001

## STAGE ONE INSTRUCTIONS

1. Remove the vacuum slides from carbs. Remove stock needles and spacers, noting order of assembly (Fig. A).
2. Install the Dynojet needles on groove #3 from the top. Use all stock spacers (Fig. A). The small Dynojet washers are for half step increments and do not have to be installed at this time. **NOTE:** The DSP77 springs do not have to be used, they are supplied in case the stock springs are misplaced. After installing the slides in the carbs be sure to check slide movement manually.
3. Remove the stock main jets and replace with the Dynojet main jets provided. If you are running the stock exhaust install the DJ126 main jets in the two outside cylinders (1&4) and the DJ124 main jets in the inside two cylinders (2&3). If you are running an aftermarket exhaust or slip-on with a high flowing baffle, use the DJ130 main jets in the outside two cylinders (1&4) and the DJ128 main jets in the inside two cylinders (2&3). Be sure that the jet you are changing is the main jet.
4. Locate the fuel mixture plug (Fig. B). If you see a screw head at Fig. B proceed to adjusting procedure. With the DD #5/32 drill bit provided carefully drill through the plugs. **NOTE:** The mixture screw is directly underneath this plug, be ready to pull back on the drill the instant you break through. Use screw provided to secure and remove this plug. Carefully turn mixture screws clockwise until lightly seated, then back out 2-1/2 turns.

**DYNOJET**  
3163CA.001

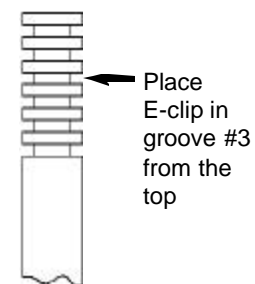

Fig. A

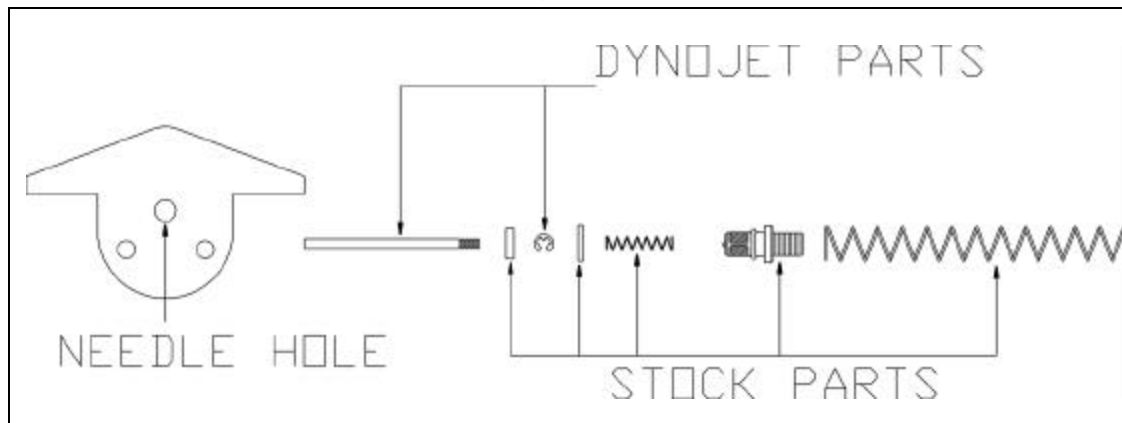

Fig. B

