

Thank you for purchasing this Dynojet kit. This kit has been developed for a motorcycle which is set to the parameters listed at the right in the "Stage" description. If your motorcycle does not meet any of these parameters please check with Dynojet before installation. For technical assistance contact your Dynojet distributor or call Dynojet U.S.A. (800)-992-4993

2191 Mendenhall Dr. Suite 105  
 North Las Vegas, NV 89081  
 TEL: 702-399-1423  
 FAX: 702-399-1431  
 8am-5pm Pacific Time  
 Monday through Friday

Website Address  
<http://www.dynojet.com>

The manufacturer and seller make no warranties express or implied which extend beyond the description of the goods contained herein. Any description of this product is for the purpose of identifying it and shall not be deemed to create an express warranty.



**4128.002**

U.S Models Only

*1988-2000 Yamaha XV750*

**Stage 1**

For mildly tuned machines using the stock airbox, with stock or K&N filter. May also be used with a good aftermarket exhaust system  
 K&N filter # YA-1186

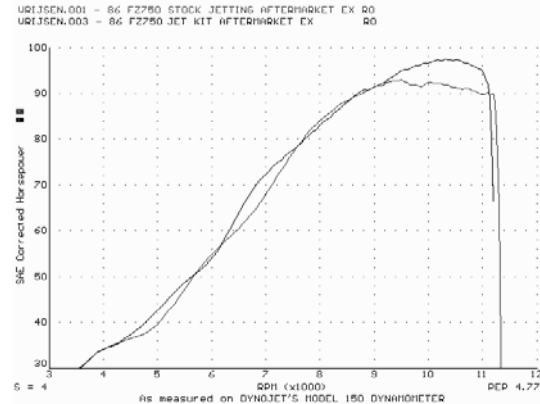

*This graph shows a typical gain with a Dynojet jet kit.*

# WARNING

**NO SMOKING!  
 NO OPEN FLAME!  
 WHILE INSTALLING  
 YOUR DYNOJET KIT**

Parts List		
2	Main Jets	DJ114
2	Main Jets	DJ118
2	Fuel Needles	DNT604
2	Adjusting Washers	DW0001
2	E-clips	DE0001
1	Plug Drill	DD #5/32
1	Screw	DS0001

## STAGE ONE INSTRUCTIONS

**Dynojet**

**4128.002**

**NOTE: It is not necessary to completely remove the carburetors from the motorcycle to install this kit.**

1. Remove the vacuum slides from the carbs. Remove the stock needles and spacers, noting the order of assembly (Fig.A).
2. Install the Dynojet needles on groove #5 from the top. Use all stock spacers (Fig. A). Install the small Dynojet washer above the E-clip.
3. It is not necessary to remove the float bowls to remove the main jets. The main jets can be accessed by removing the drain plug and using a stubby screwdriver to loosen the jet. Then use a toothpick to unscrew the jet. Remove the stock main jets and replace with Dynojet main jets provided. If you are running the stock exhaust install the DJ114 main jets. If you are running an aftermarket exhaust or slip-on with high flow baffle use the DJ118 main jets. Be sure that the jets you are changing are the main jets.
4. Locate the fuel mixture plug (Fig. B). If you see a screw head at Fig. B then proceed to the adjusting procedure. With the DD #5/32 drill bit provided carefully drill through the plug. **NOTE: The mixture screw is directly underneath this plug, be ready to pull back on the drill the instant you break through.** Use screw provided to secure and remove this plug. Carefully turn the mixture screws clockwise until lightly seated, then back out 1-1/2 turns.

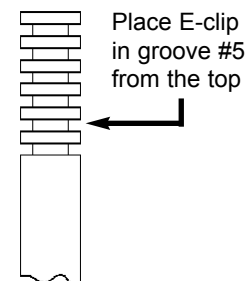

Fig. A

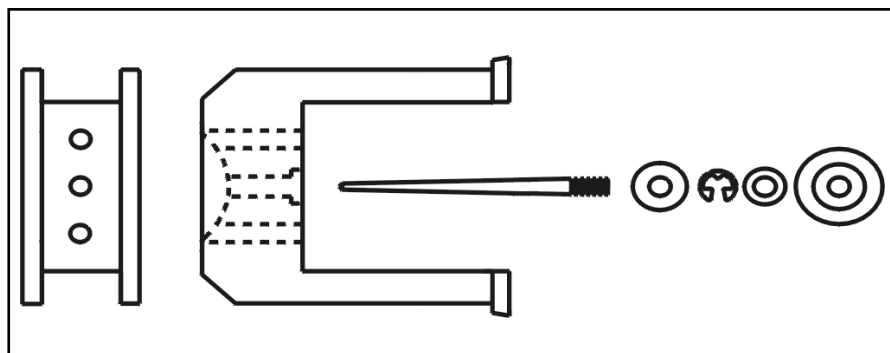

Fig. B

