

Thank you for purchasing this Dynojet kit. This kit has been developed for a motorcycle which is set to the parameters listed at the right in the "Stage" description. If your motorcycle does not meet any of these parameters please check with Dynojet before installation. For technical assistance contact your Dynojet distributor or call Dynojet U.S.A. (800)-992-4993

2191 Mendenhall Dr. Suite 105
 North Las Vegas, NV 89031
 TEL: 702-399-1423
 FAX: 702-399-1431
 8am-5pm Pacific Time
 Monday through Friday

Website Address
<http://www.dynojet.com>

The manufacturer and seller make no warranties express or implied which extend beyond the description of the goods contained herein. Any description of this product is for the purpose of identifying it and shall not be deemed to create an express warranty.



4161CA.001

California Models Only

1999-2000 Yamaha YZF600 R6

Stage 1

For mildly tuned machines using the stock airbox, with stock or K&N filter. May also be used with a good aftermarket exhaust system
 K&N filter #YA-6099

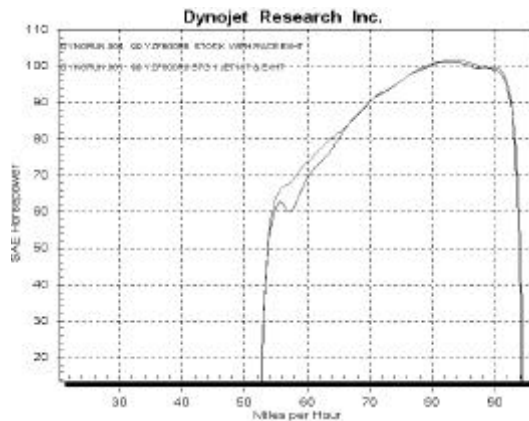

This graph shows a typical gain with a Dynojet jet kit.

WARNING

**NO SMOKING!
 NO OPEN FLAME!
 WHILE INSTALLING
 YOUR JET KIT**

Parts List		
4	Main Jets	DJ134
4	Main Jets	DJ138
4	Fuel Needles	DNO310
8	Adjusting Washers	DW0001
4	E-Clips	DE0001
1	Plug Drill	DD #5/32
1	Screw	DS0001

STAGE ONE INSTRUCTIONS

DYNOJET

4161CA.001

1. Remove the vacuum slides from the carbs. Remove the stock needles and spacers, noting order of assembly (Fig. A). To remove the needles from the slides, squeeze the two arrows together and pull out (Fig. B).
2. Install the Dynojet needles on groove #3 from the top. Use all stock spacers (Fig. A). Install the small Dynojet washers above the E-clip (2 for each needle). After installing the slides in the carbs be sure to check slide movement manually.
3. Install the Dynojet main jets provided. Install the DJ134 main jets when using a stock exhaust. Install the DJ138 main jets when using an aftermarket slip-on or full exhaust with a high flow baffle. Be sure that the jet you are changing is the main jet.
4. Locate the fuel mixture plug (Fig. C). If you see a screw head at Fig. C proceed to adjusting procedure. With the DD #5/32 drill bit provided carefully drill through the plugs. **NOTE:** The mixture screw is directly underneath this plug, be ready to pull back on the drill the instant you break through. Use screw provided to secure and remove this plug. Carefully turn mixture screws clockwise until lightly seated, then back out 2 turns.

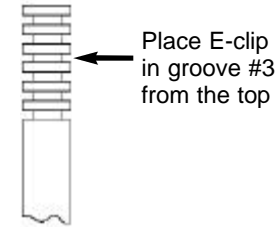

Fig. A

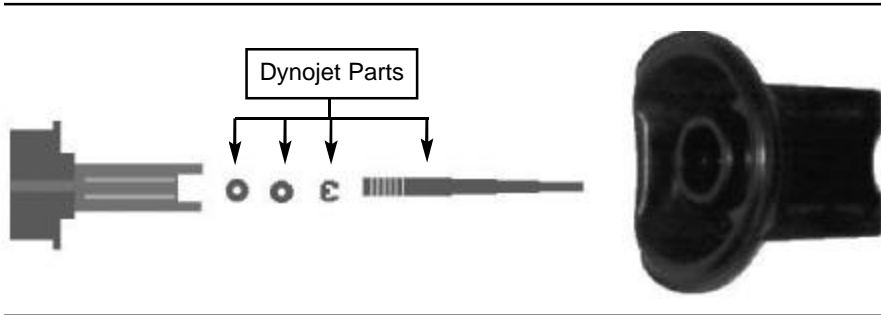
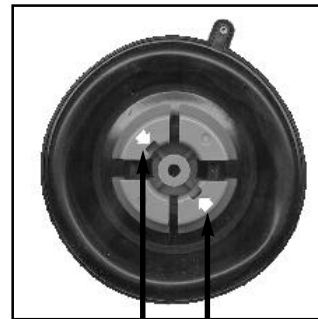

Fig. B



Squeeze Here

Fig. C



Mixture Screw