

Thank you for purchasing this Dynojet kit. This kit has been developed for a motorcycle which is set to the parameters listed at the right in the "Stage" description. If your motorcycle does not meet any of these parameters, please check with Dynojet before installation. For technical assistance contact your Dynojet distributor or call Dynojet U.S.A. (800)-992-4993

2191 Mendenhall Dr. Suite 105
 North Las Vegas, NV 89081
 TEL: 702-399-1423
 FAX: 702-399-1431
 8am-5pm Pacific Time
 Monday through Friday

Website Address
<http://www.dynojet.com>

The manufacturer and seller make no warranties express or implied which extend beyond the description of the goods contained herein. Any description of this product is for the purpose of identifying it and shall not be deemed to create an express warranty.



8104.002

U.S models only

1995-96 Buell S2 Thunderbolt
 Keihin CV Carb w/Accel. Pump

For mildly tuned machines using the stock or high flow airbox and or filter. May also be used with a good aftermarket exhaust system

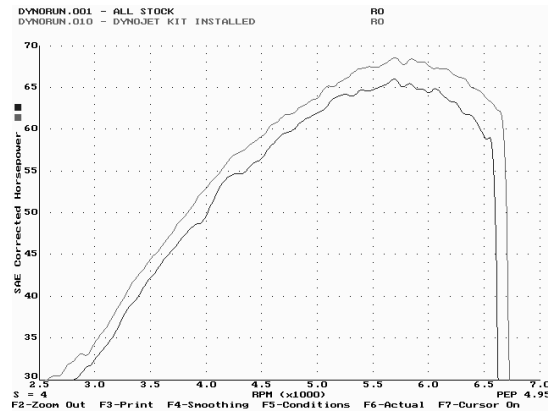

This graph shows a typical gain with a Dynojet jet kit.

WARNING

**NO SMOKING!
 NO OPEN FLAME!
 WHILE INSTALLING
 YOUR DYNOJET KIT**

Parts List

1	Main Jet	DJ170
1	Main Jet	DJ180
1	Main Jet	DJ190
1	Fuel Needle	DNO855
1	E-Clip	DE0001
3	Adjusting Washers	DW0001
1	Emulsion Tube	DET001
1	Slide Spring	DSP009
1	Slide Drill	DD #29
1	Plug Drill	DD #5/32
1	Screw	DS0001

STAGE ONE INSTRUCTIONS

Dynojet

8104.002

1. Remove the carb top, slide spring, needle retainer and slide noting order of assembly (Fig. A). Locate the slide lift hole in Fig. A. Using the drill bit provided (DD #29) enlarge the slide lift hole. **Do not drill the needle hole.**
2. Install the e-clip on groove #4 of the Dynojet needle. Install the Dynojet washers above the e-clip. Install the Dynojet slide spring (DSP009) in place of the stock slide spring. Make sure the spring is aligned properly.
3. Remove carburetor float bowl. Remove stock main jet and remove the emulsion tube (Fig. B), sometimes referred to as the main jet holder. Replace the stock emulsion tube with the Dynojet tube provided (DET001). When the Dynojet tube is fully seated there will still be threads visible. Install the Dynojet main jet provided. Use DJ180 with a completely stock bike. Use DJ190 with an aftermarket airbox, exhaust, or cam.
4. Locate the fuel mixture plug (Fig. B), if you see a screw head at Fig. B proceed to the adjusting procedure. With the 5/32 drill provided, carefully drill through the plug. **NOTE: The mixture screw is directly underneath this plug, be ready to pull back on the drill the instant you break through.** Use screw provided to secure and remove this plug. Carefully turn the mixture screw in until lightly seated, then back out 3 turns.

Note:

In order for this kit to work properly, your pilot circuit must be completely stock. Also make sure that the pilot jet has not been drilled larger.

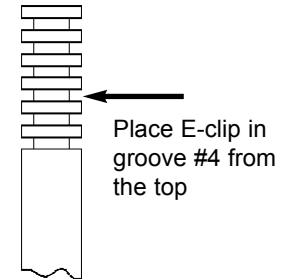

Fig. A

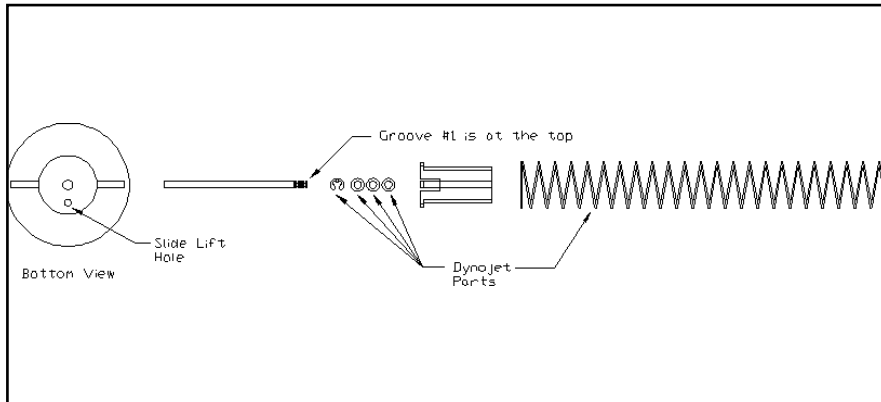

Fig. B

