

Thank you for purchasing this Dynojet kit. This kit has been developed for a motorcycle which is set to the parameters listed at the right in the "Stage" description. If your motorcycle does not meet any of these parameters please check with Dynojet before installation. For technical assistance contact your Dynojet distributor or call Dynojet U.S.A. (800)-992-4993



# WARNING

**NO SMOKING!  
NO OPEN FLAME!  
WHILE INSTALLING  
YOUR DYNOJET KIT**

2191 Mendenhall Dr. Suite 105  
North Las Vegas, NV 89031  
TEL: 702-399-1423  
FAX: 702-399-1431  
8am-5pm Pacific Time  
Monday through Friday

Website Address  
<http://www.dynojet.com>

The manufacturer and seller make no warranties express or implied which extend beyond the description of the goods contained herein. Any description of this product is for the purpose of identifying it and shall not be deemed to create an express warranty.

**E1199.001**

European Models Only

*2004 Honda CBF600*  
**Stage 1**

For mildly tuned machines using the stock or modified airbox, with stock or K&N filter. May also be used with a good aftermarket exhaust system. K&N filter # N/A

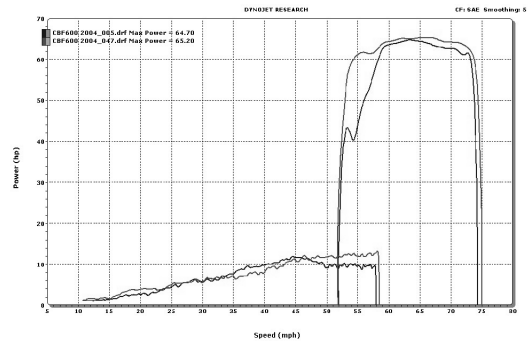

*This graph shows a typical gain with a Dynojet jet kit.*

## Parts List

4	Main Jets	DJ098
4	Main Jet	DJ100
4	Main Jet	DJ102
4	Main Jet	DJ104
4	Main Jet	DJ106
4	Fuel Needles	DNO124
4	Adjusting Washers	DW0001
4	E-clips	DE0001

## STAGE ONE INSTRUCTIONS

**Dynojet**

**E1199.001**

1. Remove vacuum slides from carbs. Remove spring from slide. Thread one of the slide cover screws into the center of the needle retainer (Fig. A) and pull up gently. Remove stock needles and spacers, noting order of assembly (Fig. B).
2. Install Dynojet needles on groove #3 from the top. Use all stock spacers (Fig. B). Install the small Dynojet washers above the E-clip. After installing the slides in the carbs be sure to check slide movement manually.
3. Remove the stock main jets and replace with Dynojet main jets provided. If you are running the stock exhaust install the DJ100 main jets. If you are running an aftermarket exhaust or slip-on with a high flowing baffle, use the DJ104 main jets. Be sure that the jets you are changing are the main jets
4. Locate the fuel mixture screw (Fig. C). Carefully turn the screws clockwise until they lightly seat and then back out 3 turns or until the best idle is achieved.

Fig. A

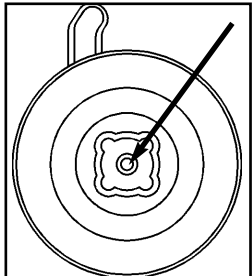

Fig. B

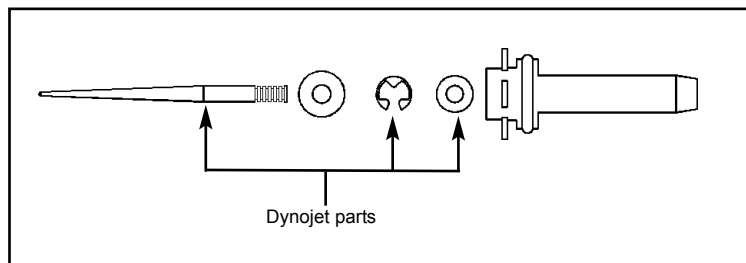
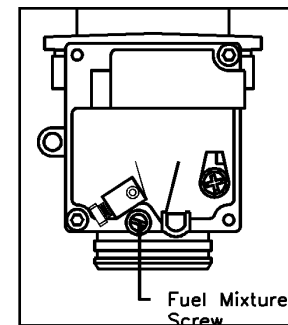

Fig. C



Place E-clip in groove #3 from the top

