

Thank you for purchasing this Dynojet kit. This kit has been developed for a motorcycle which is set to the parameters listed at the right in the "Stage" description. If your motorcycle does not meet any of these parameters please check with Dynojet before installation. For technical assistance contact your Dynojet distributor or call Dynojet U.S.A. (800)-992-4993

2191 Mendenhall Dr. Suite 105
 North Las Vegas, NV 89031
 TEL: 702-399-1423
 FAX: 702-399-1431
 8am-5pm Pacific Time
 Monday through Friday

Website Address
<http://www.dynojet.com>

The manufacturer and seller make no warranties express or implied which extend beyond the description of the goods contained herein. Any description of this product is for the purpose of identifying it and shall not be deemed to create an express warranty.



E1178.001

European Models Only

1998-99 Honda CBR900RR

Stage 1

For mildly tuned machines using the stock air-box, with stock or K&N filter. May also be used with a good aftermarket exhaust system
 K&N filter #HA-9092

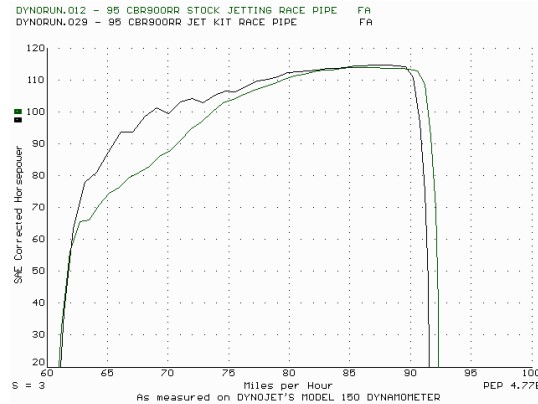

This graph shows a typical gain with a Dynojet jet kit.

WARNING

**NO SMOKING!
 NO OPEN FLAME!
 WHILE INSTALLING
 YOUR DYNOJET KIT**

Parts List		
4	Main Jet	DJ122
4	Main Jet	DJ124
4	Main Jet	DJ126
4	Fuel Needle	DNO129
4	E-Clips	DE0001
4	Adjusting Washers	DW0001
4	Slide Springs	DSP008

STAGE ONE INSTRUCTIONS

DYNOJET

E1178.001

1. Remove vacuum slides from carbs. Remove spring from slide. Thread one of the slide cover screws into the center of the needle retainer (Fig. A) and pull up gently. Remove stock needles and spacers, noting order of assembly (Fig. B).
2. Install Dynojet needles on groove #3 from the top. Use all stock spacers (Fig. B). Install the small Dynojet washers above the E-clip. Install the stock needle retainers with the Dynojet slide springs (DSP008). After installing the slides in the carbs be sure to check slide movement manually.
3. Remove the stock main jets and replace with Dynojet main jets provided. If you are running the stock exhaust install the DJ122 main jets or the DJ124 main jets if using with a K&N filter. If you are running an aftermarket exhaust or slip-on with a high flowing baffle, use the DJ124 main jets or the DJ126 main jets if using with a K&N filter. Be sure that the jets you are changing are the main jets.
4. Locate the fuel mixture screw (Fig. C). Carefully turn the screws clockwise until they lightly seat and then back out 2.1/4 turns or until the best idle is achieved.

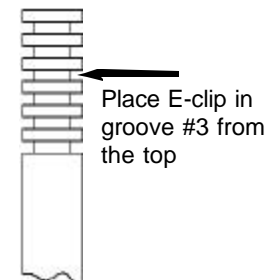

Fig. A

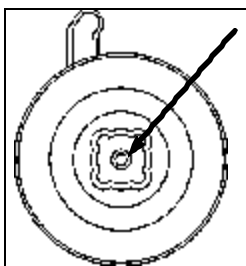

Fig. B

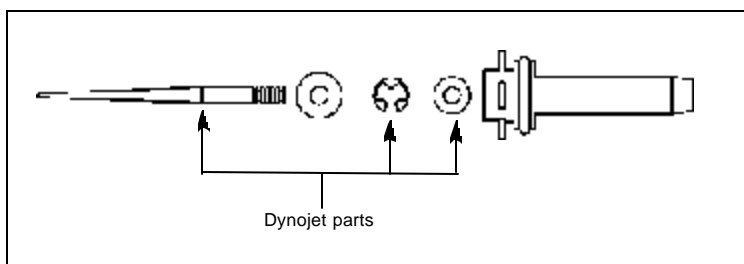

Fig. C

