

Thank you for purchasing this Dynojet kit. This kit has been developed for a motorcycle which is set to the parameters listed at the right in the "Stage" description. If your motorcycle does not meet any of these parameters please check with Dynojet before installation. For technical assistance contact your Dynojet distributor or call Dynojet U.S.A. (800)-992-4993



**E4175.001**

European Models Only

*1999-2003 Yamaha  
Road Star & Wild Star 1600*

**Stage 1**

For mildly tuned machines using the stock air-box, with stock or K&N filter. May also be used with a good aftermarket exhaust system.

K&N filter #N/A

Dynojet Research Inc.

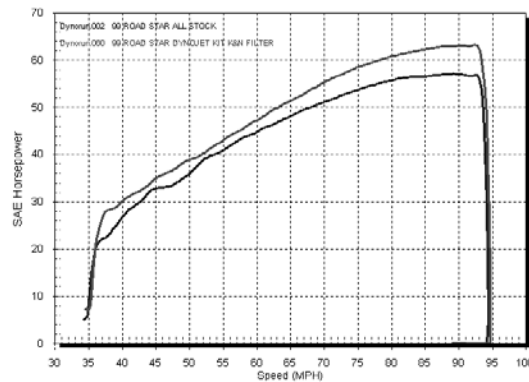

*This graph shows a typical gain with a Dynojet jet kit.*

# WARNING

**NO SMOKING!  
NO OPEN FLAME!  
WHILE INSTALLING  
YOUR DYNOJET KIT**

2191 Mendenhall Dr. Suite 105  
North Las Vegas, NV 89081  
TEL: 702-399-1423  
FAX: 702-399-1431  
8am-5pm Pacific Time  
Monday through Friday

**Website Address**  
<http://www.dynojet.com>

The manufacturer and seller make no warranties express or implied which extend beyond the description of the goods contained herein. Any description of this product is for the purpose of identifying it and shall not be deemed to create an express warranty.

## Parts List

1	Main Jet	DJ170
1	Main Jet	DJ175
1	Main Jet	DJ180
1	Main Jet	DJ185
1	Fuel Needle	DNO977
1	Adjusting Washer	DW0001
1	E-Clip	DE0001
1	Needle Spring	DSP77

## STAGE ONE INSTRUCTIONS

1. Remove the vacuum slide from carb. Remove the stock needle & spacers, noting order of assembly.
2. Install the Dynojet needle on groove #3. Use all stock spacers (Fig. A). The small Dynojet washer is for half step increment adjustments and do not need to be installed at this time.

**Note:** The DSP77 spring does not have to be used, it is supplied in case the stock spring is misplaced. After installing slide in the carb be sure to check slide movement manually.

3. Install the Dynojet main jet provided. If you are running the stock muffler use the DJ175 main jet. If you are running an aftermarket slip-on with high flowing baffle, use the DJ180 main jet. The DJ170 main jet is provided for high-altitude applications. Be sure that the jet you are changing is the main jet.

4. Remove the plastic cover and intake snorkel from the back of the airbox.

5. Locate the Fuel Mixture Screw (Fig. B). Carefully turn mixture screw clockwise until lightly seated, then back out 3-1/2 turns.

**Dynojet**  
E4175.001

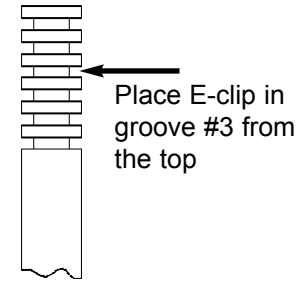

Fig. A

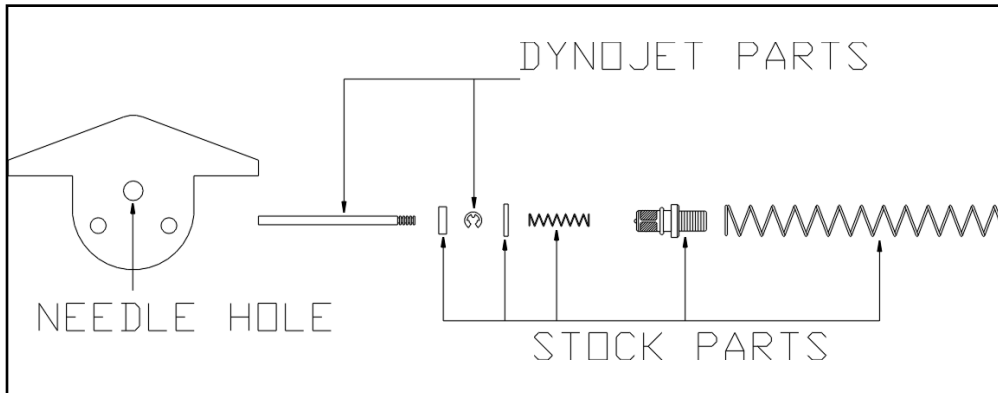
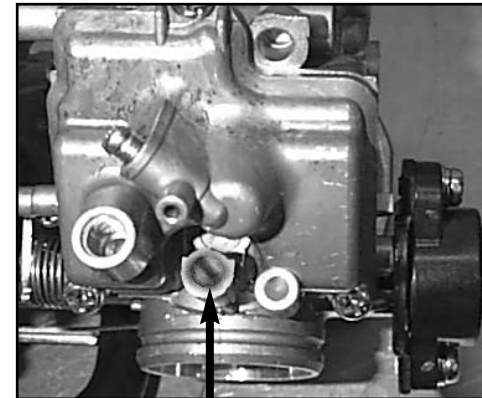

Fig. B



Fuel Mixture Screw