

# **Q105.001**

## **1997-2012 Honda**

### **250 Recon**

## **Stage 1**

For mildly tuned machines using the stock airbox with stock or aftermarket filter. May also be used with a good aftermarket exhaust system.

<b><i>Parts List</i></b>		
1	Main Jet	DJ084
1	Main Jet	DJ088
1	Main Jet	DJ092
1	Fuel Needle	DNO180
1	Adjusting Washer	DW0001
1	E-Clip	DE0001

## STAGE ONE INSTRUCTIONS

1. Unscrew the carb top. Disconnect throttle cable and remove the slide. Remove needle retainer.(Fig.A).
2. Install Dynojet needle on groove #3 for applications below 5000 feet, groove #2 for above 5000 feet, using all stock spacers. Install the Dynojet washer above the E-clip.
3. Remove stock main jet and replace with Dynojet main provided. Use the DJ092 below 3000 feet, DJ088 from 3000 to 6000 feet and DJ084 above 6000 feet. Be sure that the jet you are changing is the main jet.
4. Locate the Fuel Mixture Screw. Using a flat blade screwdriver, turn the mixture screw clockwise until it seats, then turn out 2 1/2 turns.

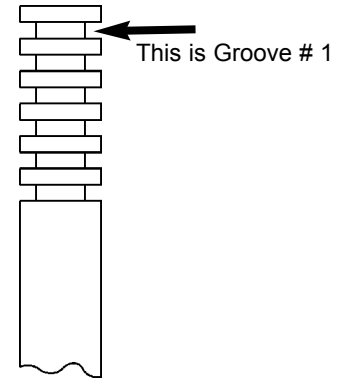

Fig.A

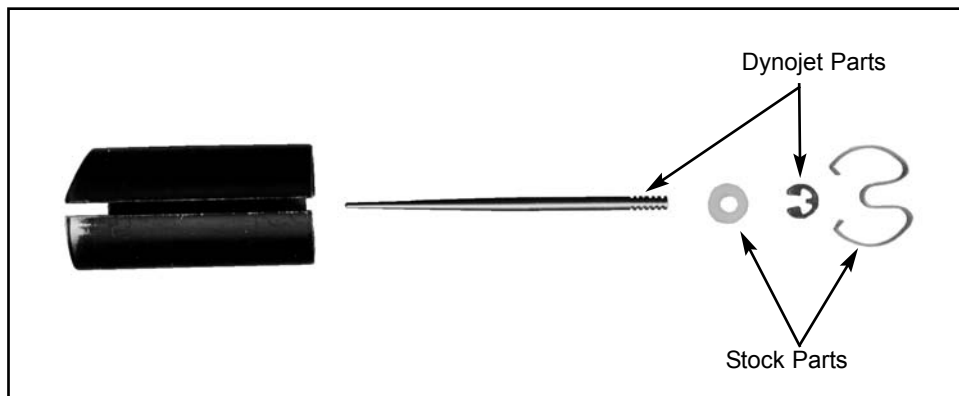

Fig.B

