

Q214.001
2003~2009 Kawasaki
KFX700
Stage 1

For mildly tuned machines using the stock airbox with stock or aftermarket filter. May also be used with a good aftermarket exhaust system.

<i>Parts List</i>		
1	Main Jet	DJ116
1	Main Jet	DJ118
1	Main Jet	DJ120
1	Main Jet	DJ122
1	Main Jet	DJ124
1	Main Jet	DJ126
1	Main Jet	DJ128
1	Main Jet	DJ130
1	Main Jet	DJ134
1	Main Jet	DJ138
2	Fuel Needles	DNO119
4	Adjusting Washers	DW0001
2	E-Clips	DE0001

STAGE ONE INSTRUCTIONS

1. Remove vacuum slides from carbs. Remove stock needles & spacers, noting order of assembly (Fig.A).
2. Install Dynojet needles on groove #5 for applications below 5000 feet, groove #4 for above 5000 feet, using all stock spacers. Install the Dynojet washers above the E-clip, 2 per needle (Fig.A).
3. Remove stock main jets and replace with Dynojet main jets provided. Use the DJ120 in the front carb and the DJ124 in the rear carb below 3000 feet, DJ118 in the front carb and the DJ122 in the rear carb from 3000 to 6000 feet and DJ116 in the front carb and the DJ120 in the rear carb above 6000 feet. When using an aftermarket exhaust with a high flow baffle, use the DJ124 in the front carb and the DJ128 in the rear carb below 3000 feet, DJ122 in the front carb and the DJ126 in the rear carb from 3000 to 6000 feet and the DJ120 in the front carb and the DJ124 in the rear carb above 6000 feet.
4. Locate the Fuel Mixture Screws (Fig.B). Using a flat blade screwdriver, turn the mixture screws clockwise until seated, then turn out 2.5 turns, 2 turns above 5000 feet.

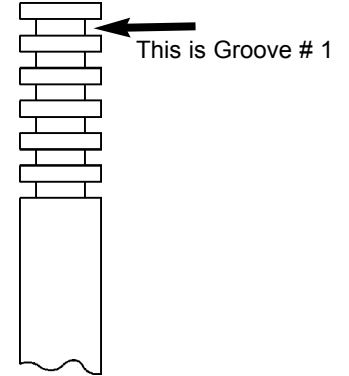

Fig.A

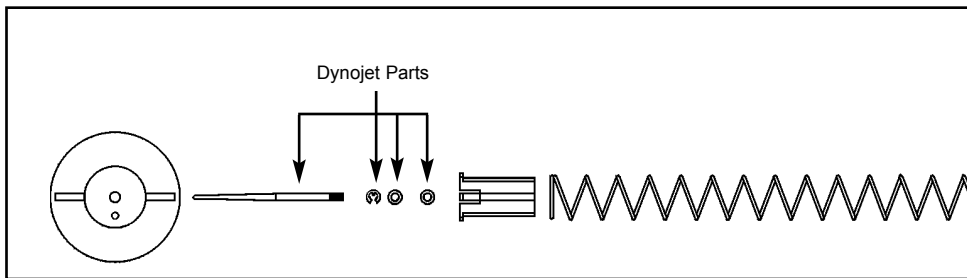

Fig.B

