

# Q436.001

## 2006-2009 Yamaha

### 450 Rhino

### Stage 1

For mildly tuned machines using the stock airbox with stock or aftermarket filter. May also be used with a good aftermarket exhaust system.

<i><b>Parts List</b></i>		
1	Main Jet	DJ124
1	Main Jet	DJ128
1	Main Jet	DJ132
1	Main Jet	DJ136
1	Main Jet	DJ140
1	Main Jet	DJ144
1	Main Jet	DJ148
1	Fuel Needle	DNO490
1	Slide Spring	DSP027
1	Needle Spring	DSP77
1	Adjusting Washer	DW0001
1	E-Clip	DE0001
1	Screw	DS0001
1	Plug Drill	DD 5/32

## STAGE ONE INSTRUCTIONS

1. Remove vacuum slide from carb. Remove stock needle & spacers, noting order of assembly (Fig.A).
2. Install Dynojet needle on groove #4 for applications below 5000 feet, groove #3 for above 5000 feet, using all stock spacers (Fig.A). Install the Dynojet slide spring (DSP027) in place of the stock slide spring. **NOTE:** *The DSP77 spring does not have to be used, it is supplied in case the stock spring is misplaced.* The Dynojet washer (DW0001) does not need to be installed at this time, it is for half step adjustments. After installing the slides in the carbs be sure to check slide movement manually before air box installation.
3. Remove stock main jet and replace with Dynojet main jet provided. Use the DJ132 below 3000 feet, DJ128 from 3000 to 6000 feet and DJ124 above 6000 feet. When using an aftermarket exhaust with a high flow baffle, Use the DJ136 below 3000 feet, DJ132 from 3000 to 6000 feet and the DJ128 above 6000 feet.
4. Locate the fuel mixture plug (Fig. B), if you see a screw head, proceed to adjusting procedure. With the plug drill DD 5/32 provided, carefully drill thru the plugs. **NOTE:** *the mixture screw is directly underneath this plug, be ready to pull back on the drill the instant you break through.* Use the screw provided to secure and remove the plug. Using a flat blade screwdriver, turn the mixture screw clockwise until it seats, then turn out 3 turns if below 3000 feet or 2.5 turns when above 6000 feet.

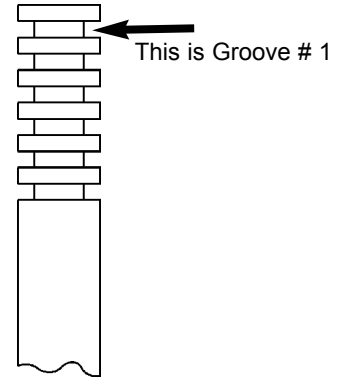

Fig.A

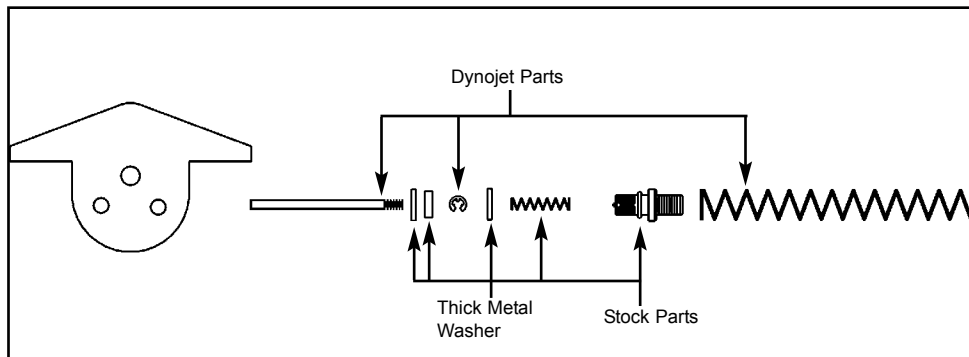

Fig.B

